

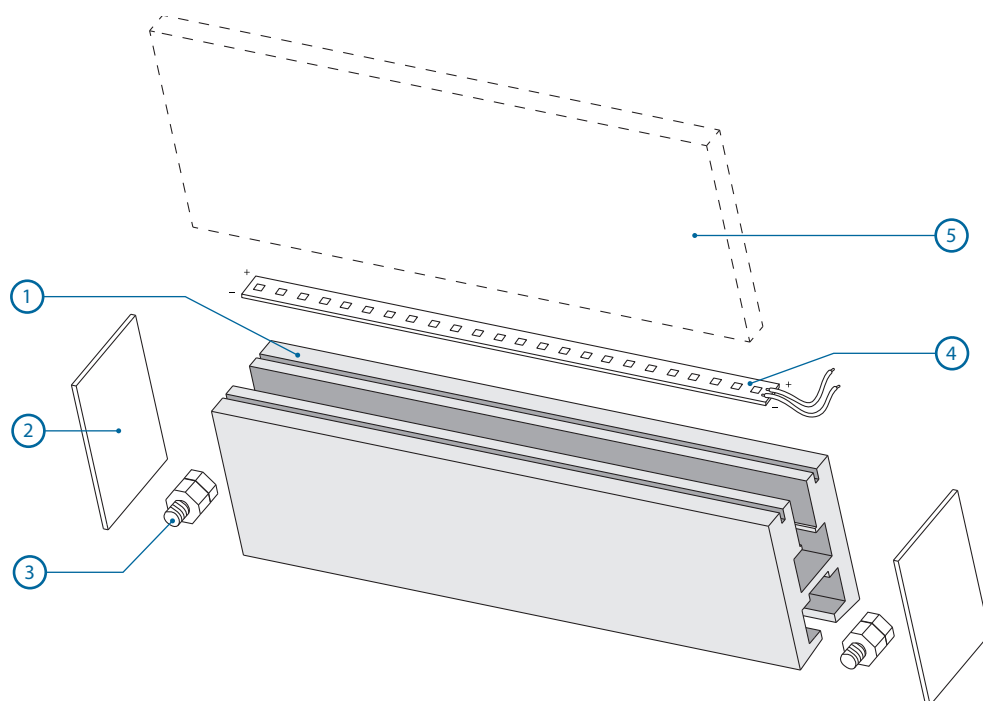

### Basic fixture components



1. SDAL-ST profile
2. End cap

SDAL-ST-EC



3. Stretching screw
4. LED strip (not included)
5. Glass (not included)

## Wiring diagram

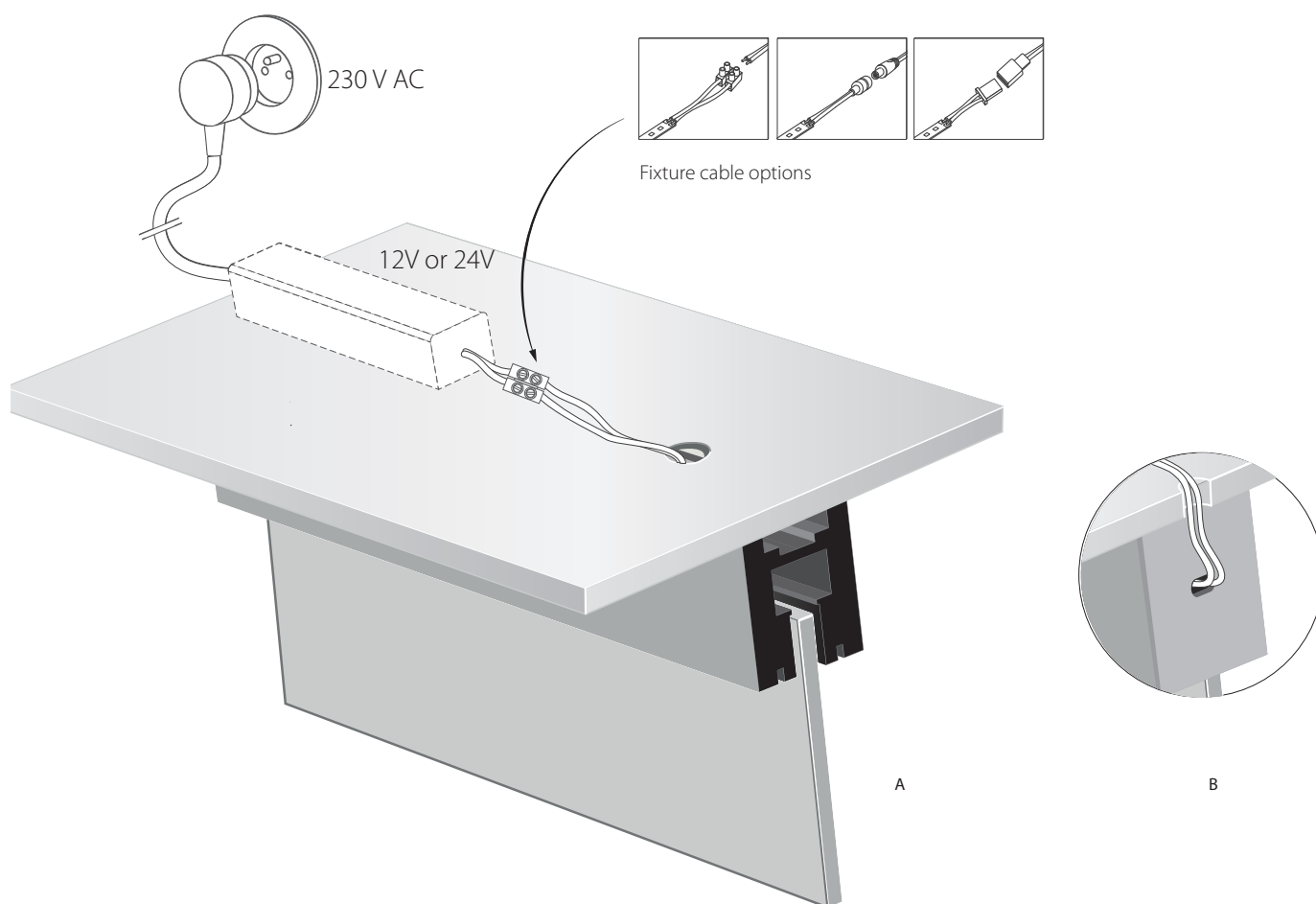

## Installation of LED strips

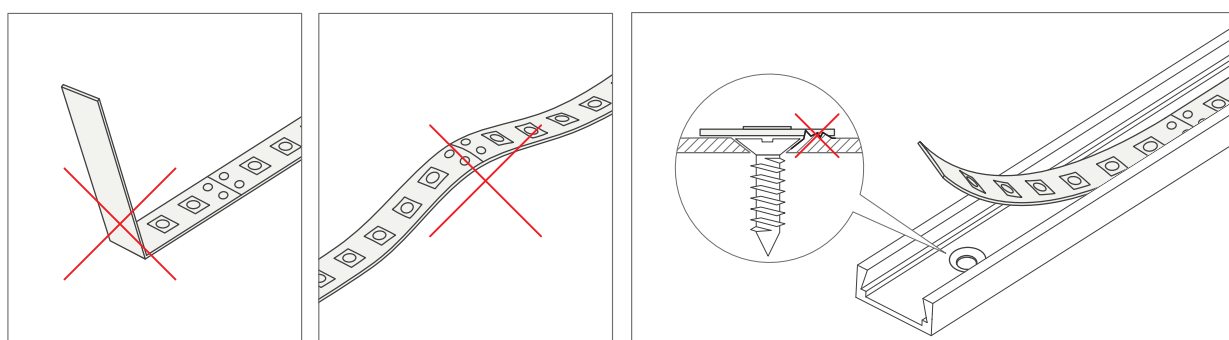

### NOTE:

- LED Strips should not be excessively bend.
- When laying LED strips to surface avoid ripples.
- The surface should be smooth, without sharp edges. Before applying the LED strip surface should be clean.

Mounting of the SDAL-ST extrusion with the use of stretching screws.

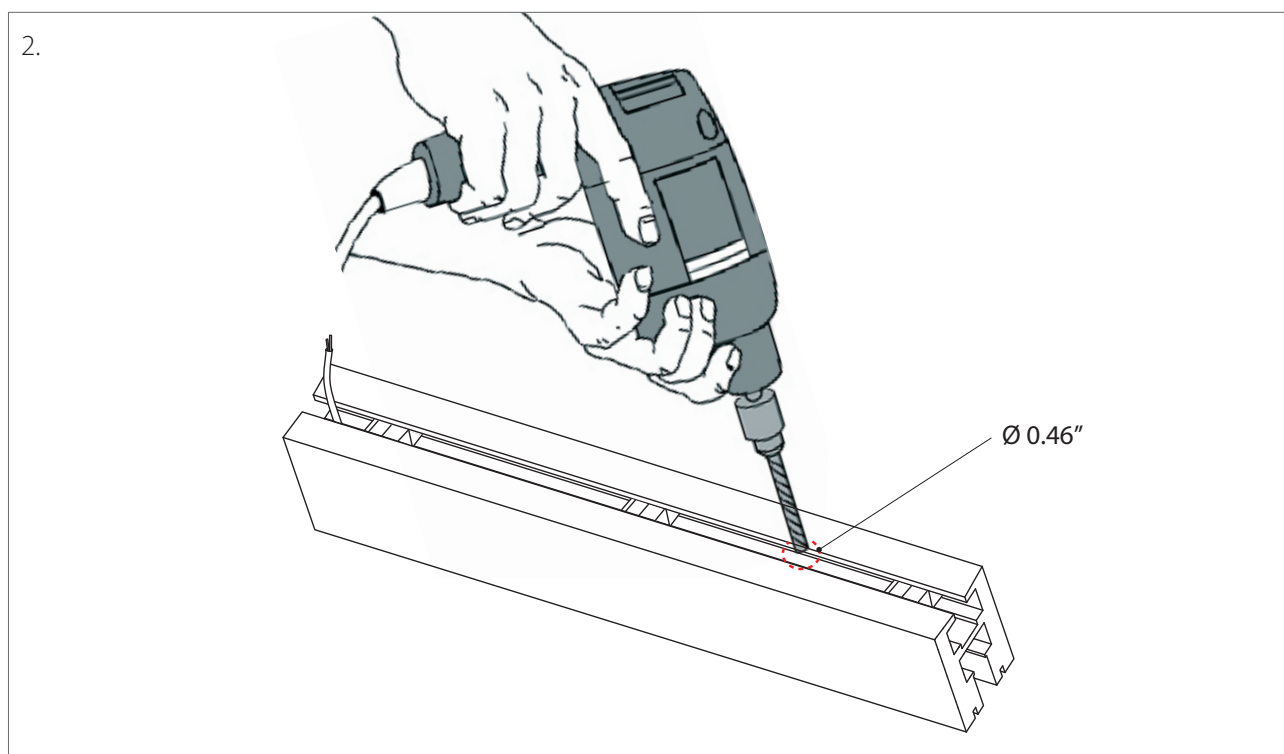
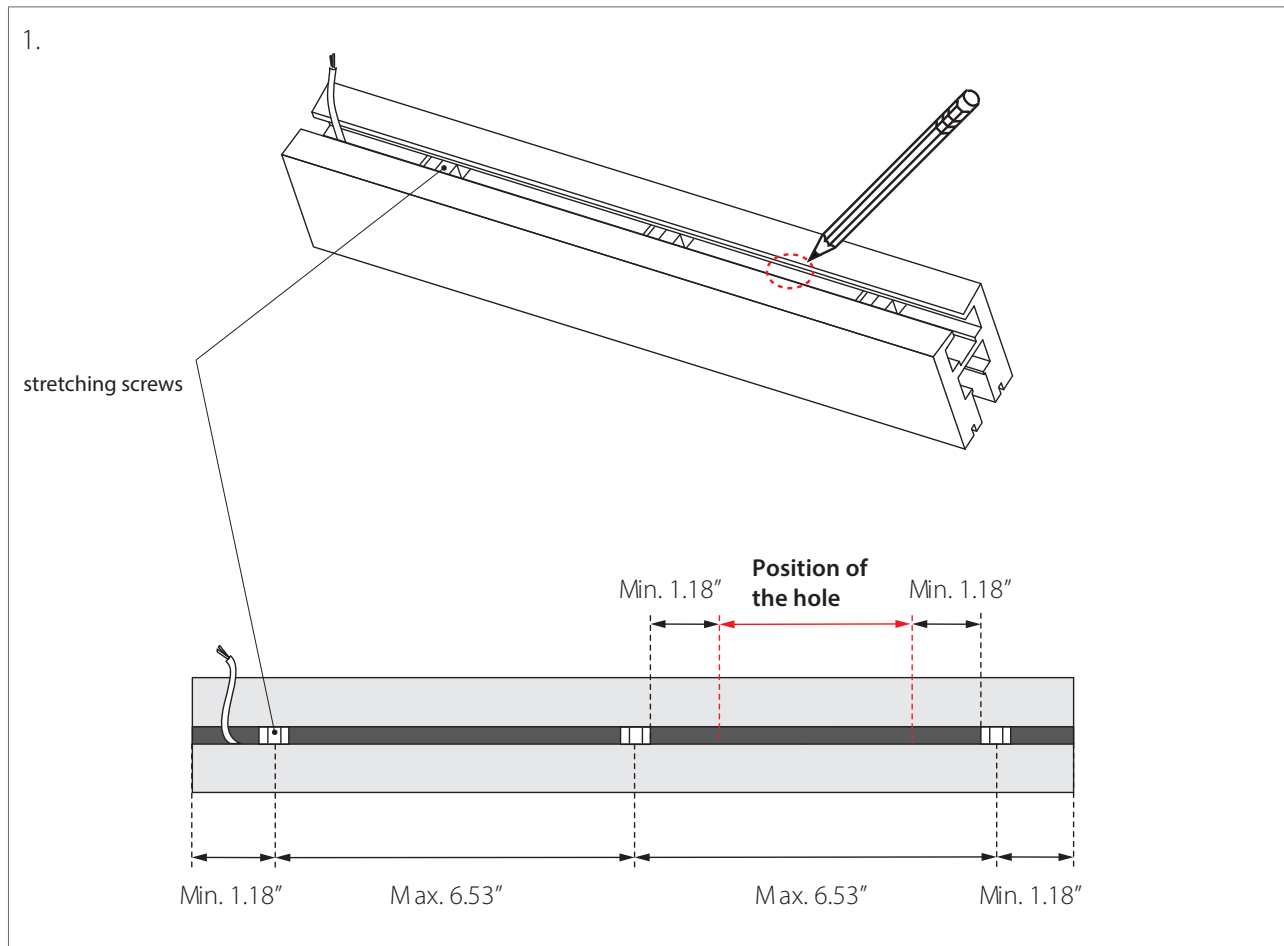

Mounting using the helping tool.

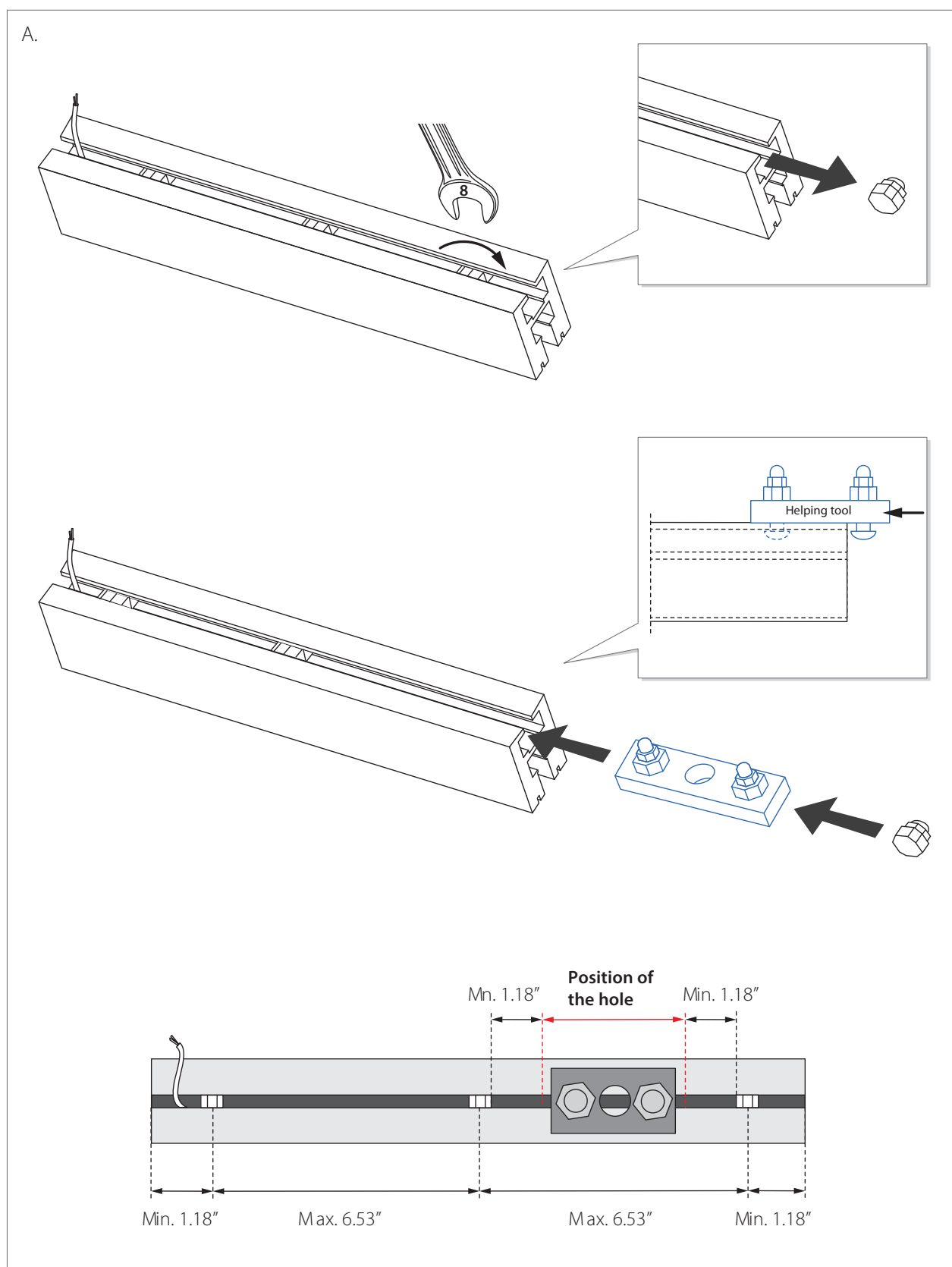

B.

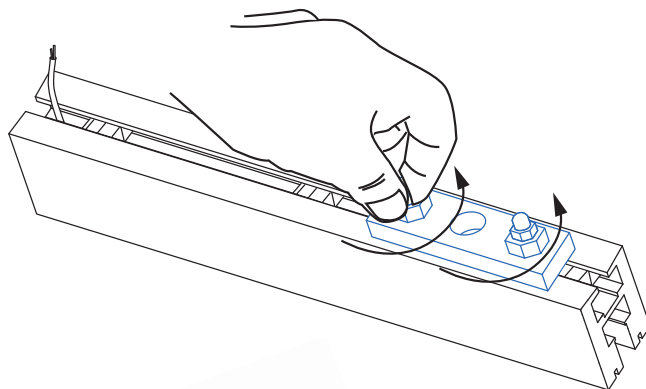

C.

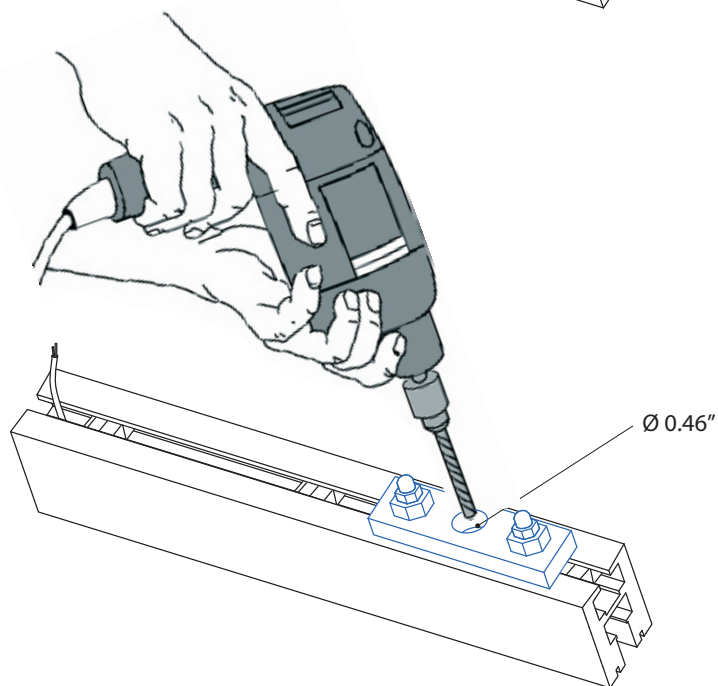

D.

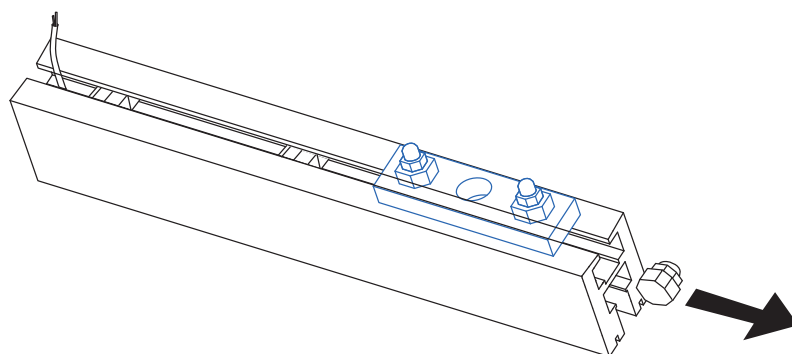

E.

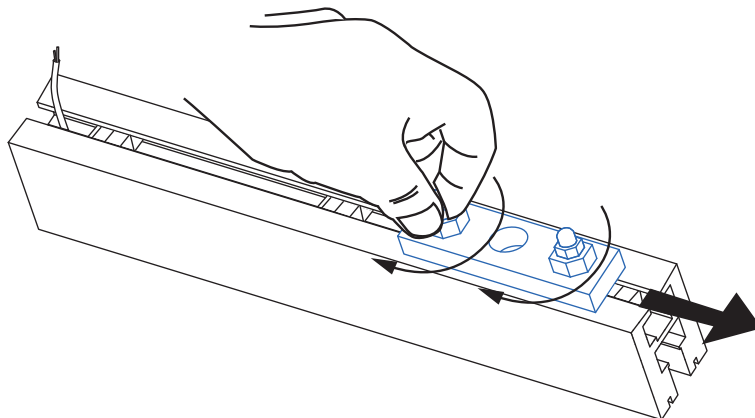

F.

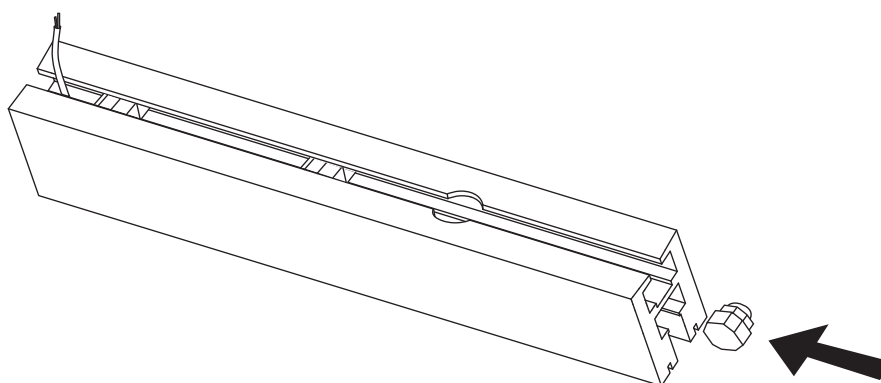

G.

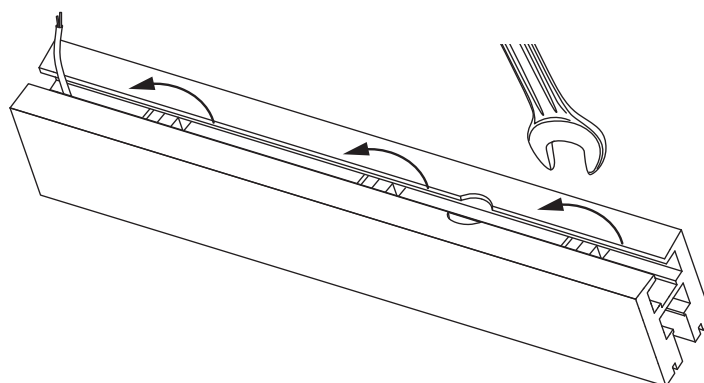

Lightly loosen the stretching screws to prevent them from sliding sideways.

3.

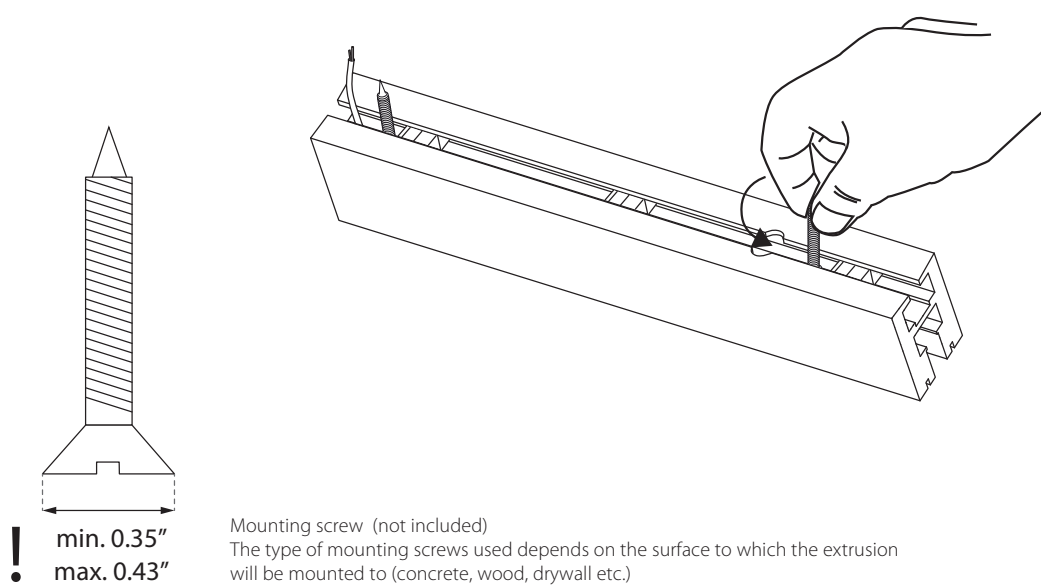

4.

hole for the LED power cable

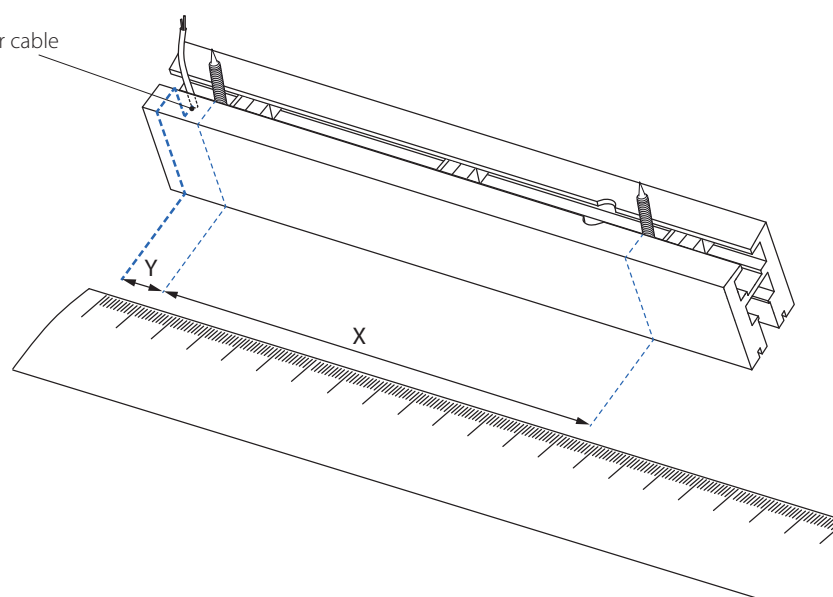

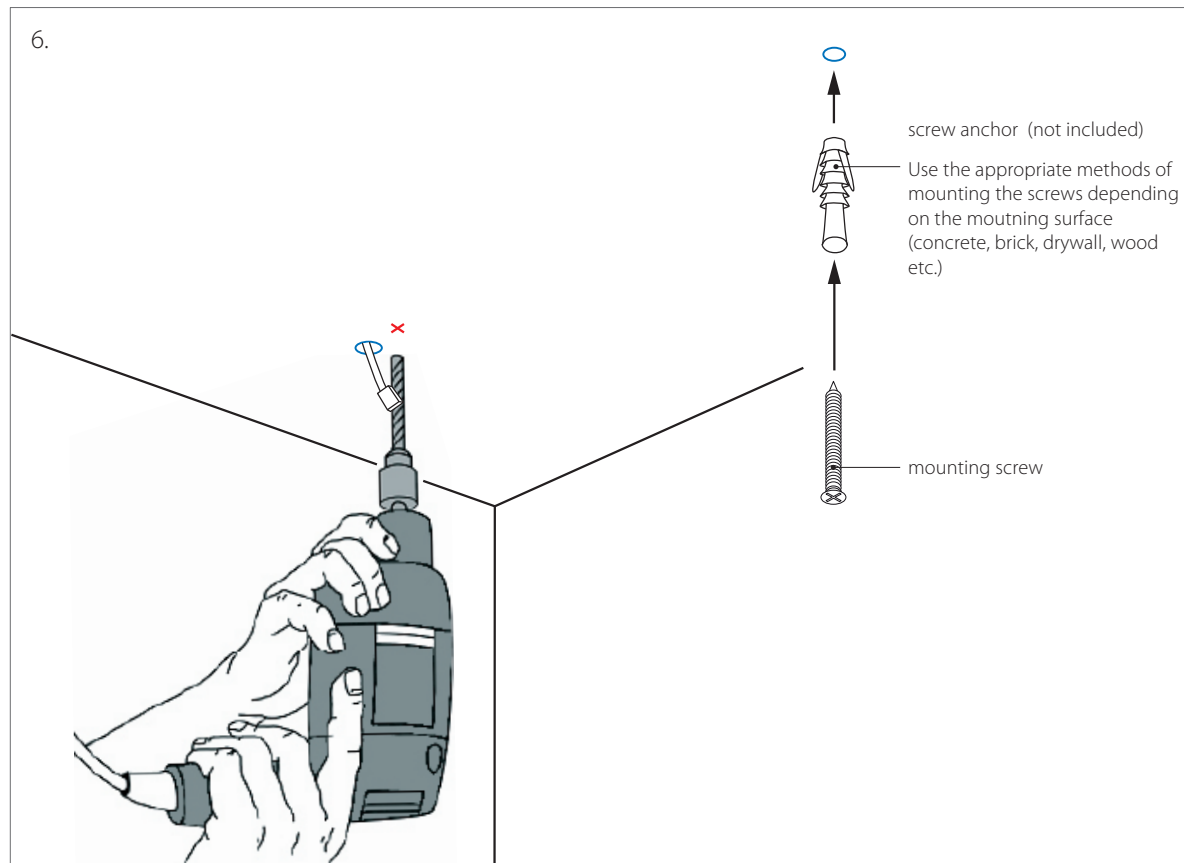
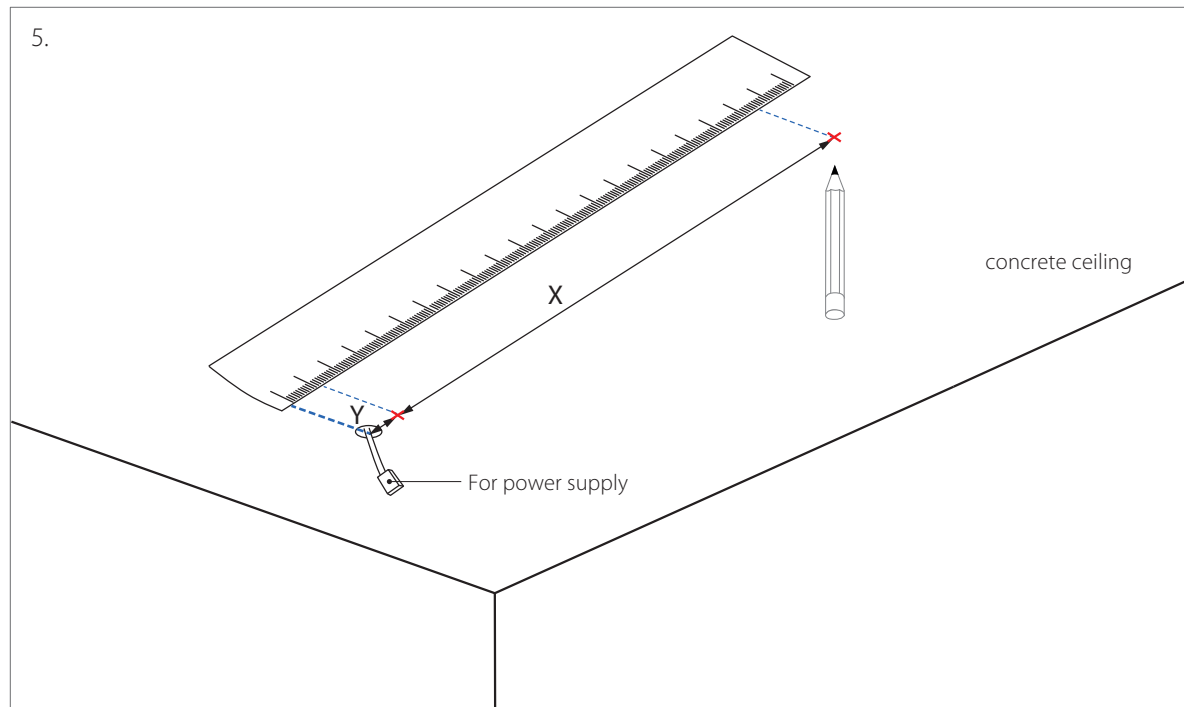

7.

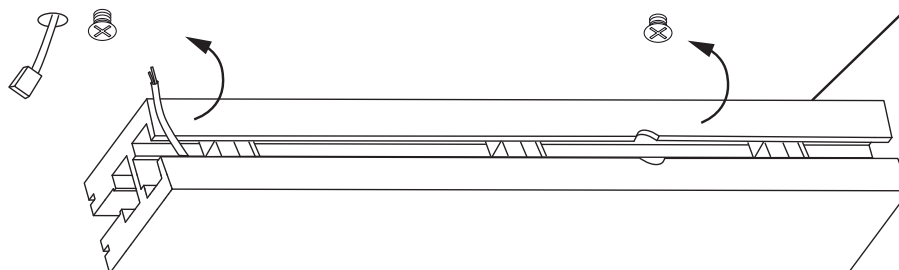

It is recommended to test the placement of the extrusion before mounting the glass.

8.

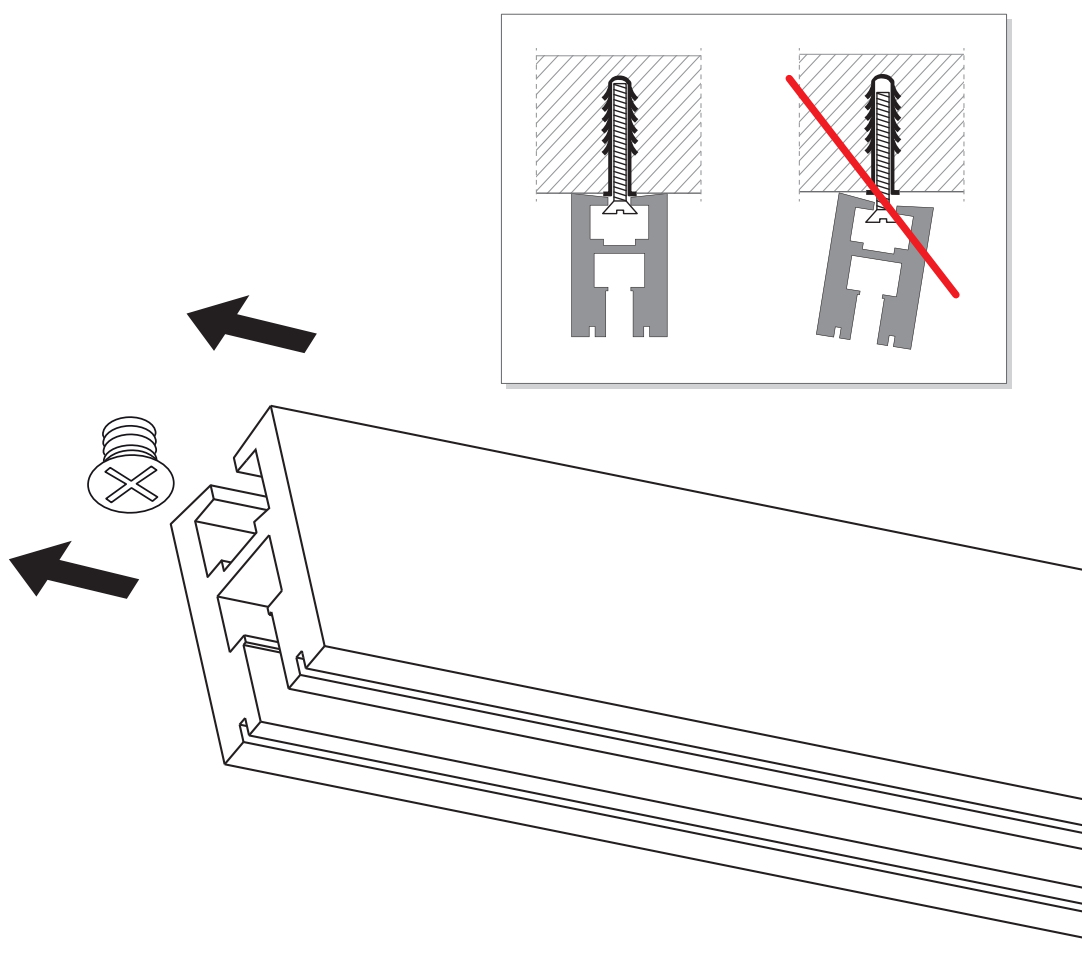

Mounting the glass.

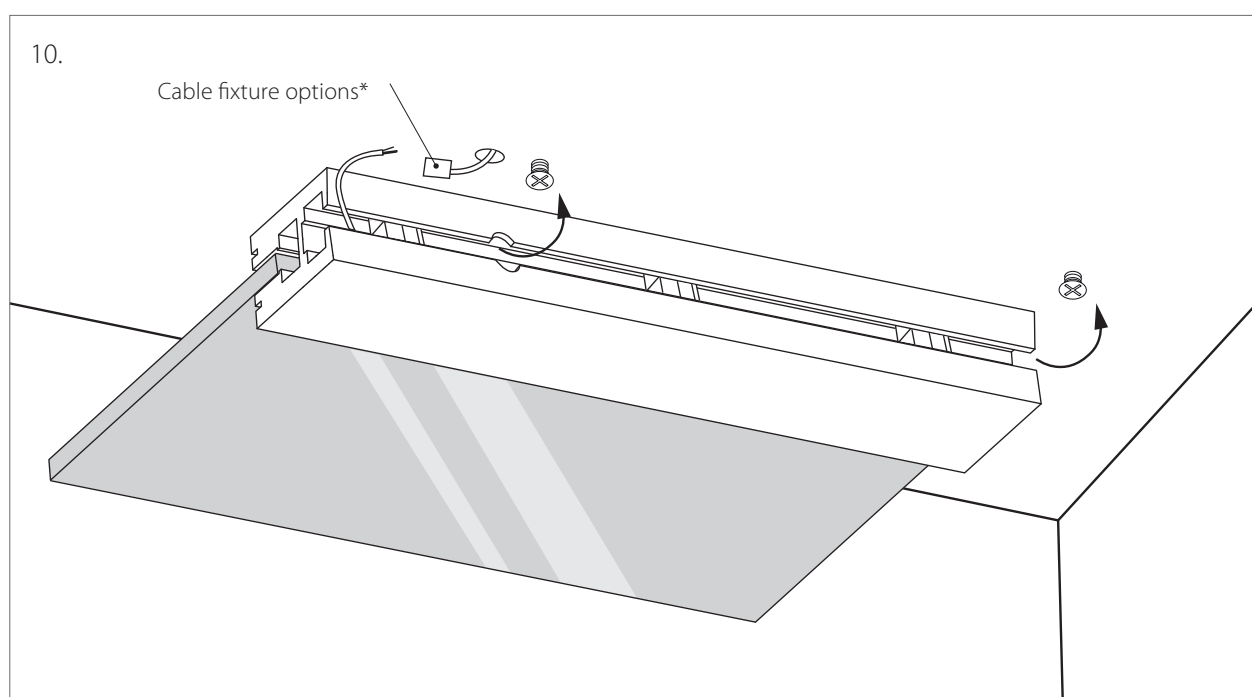
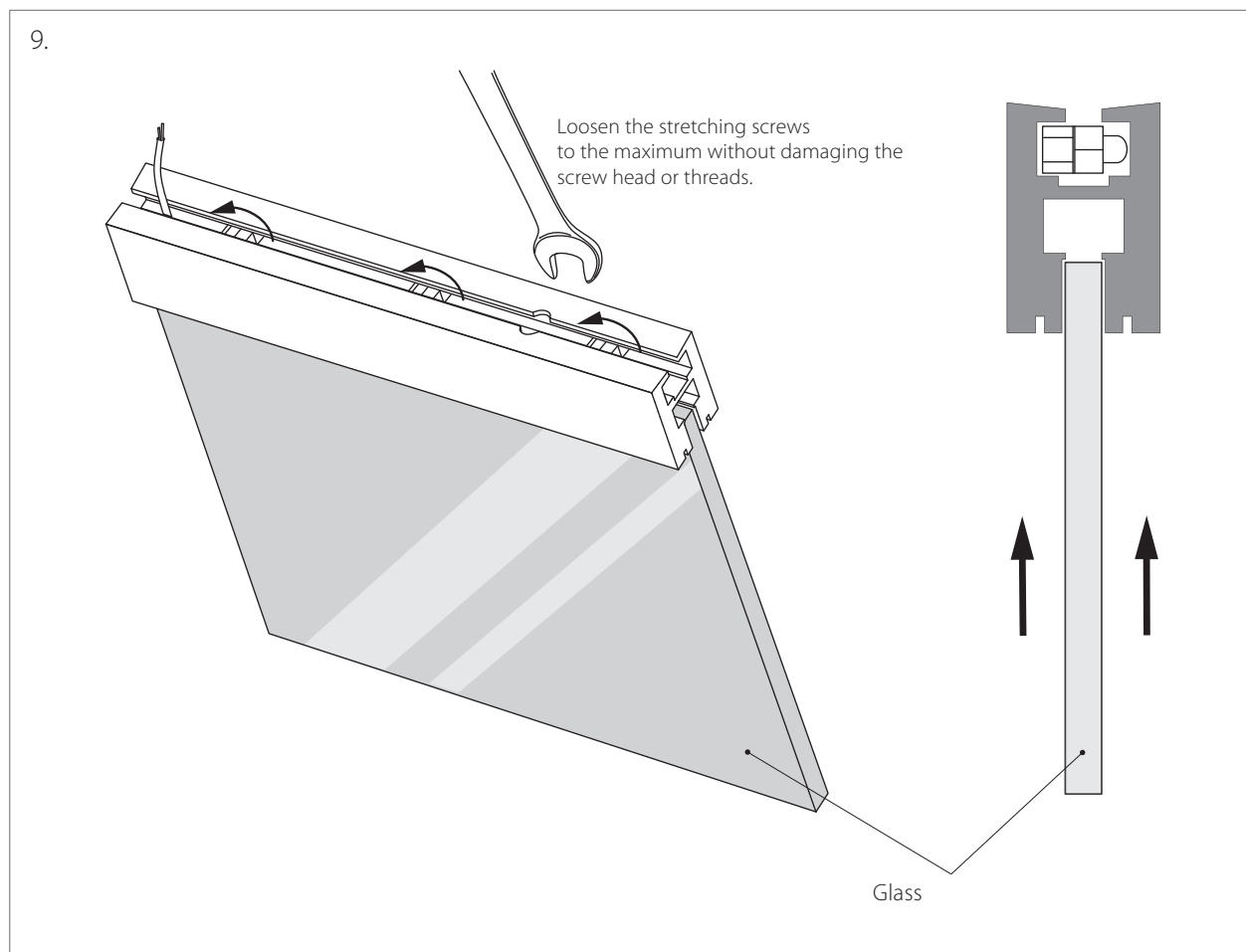



11.

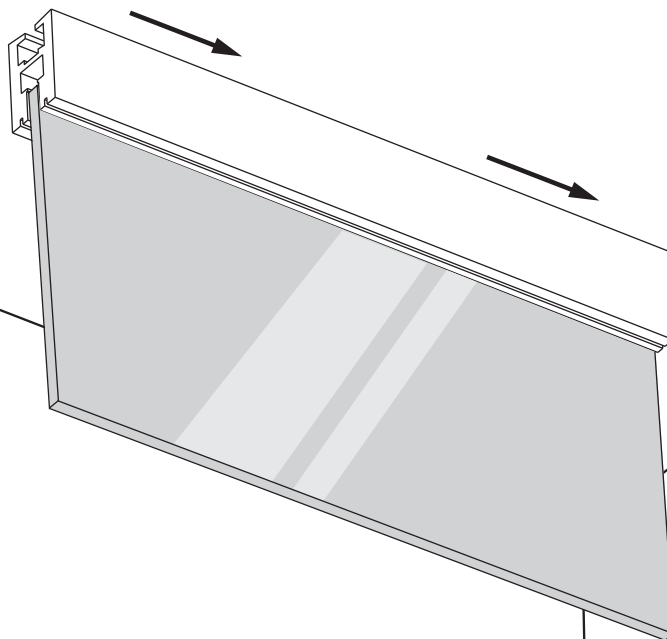

12.

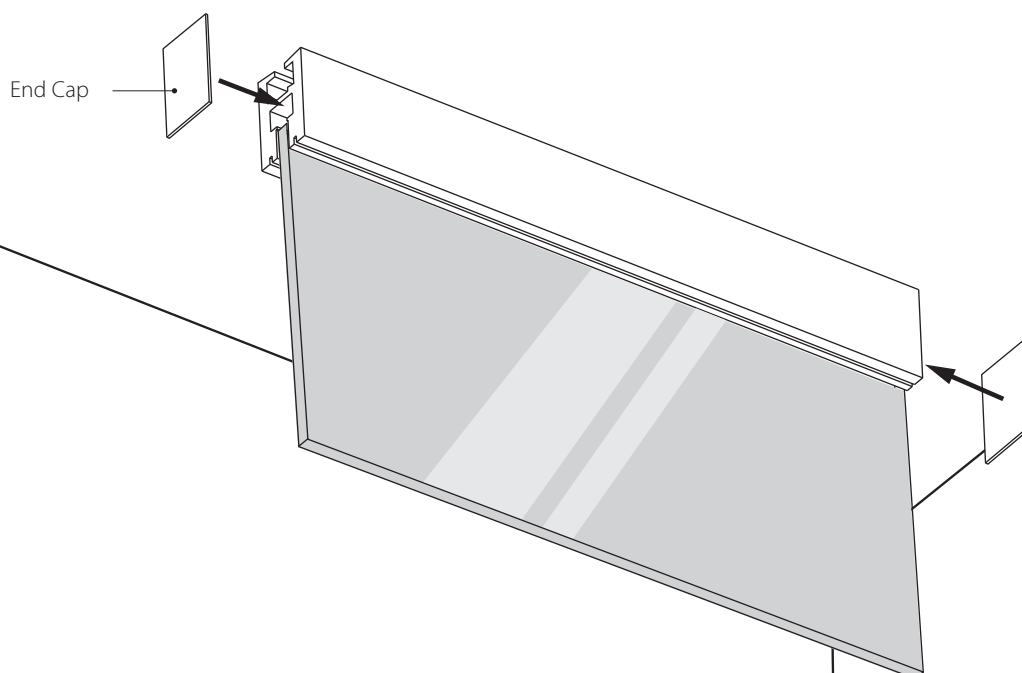

13.

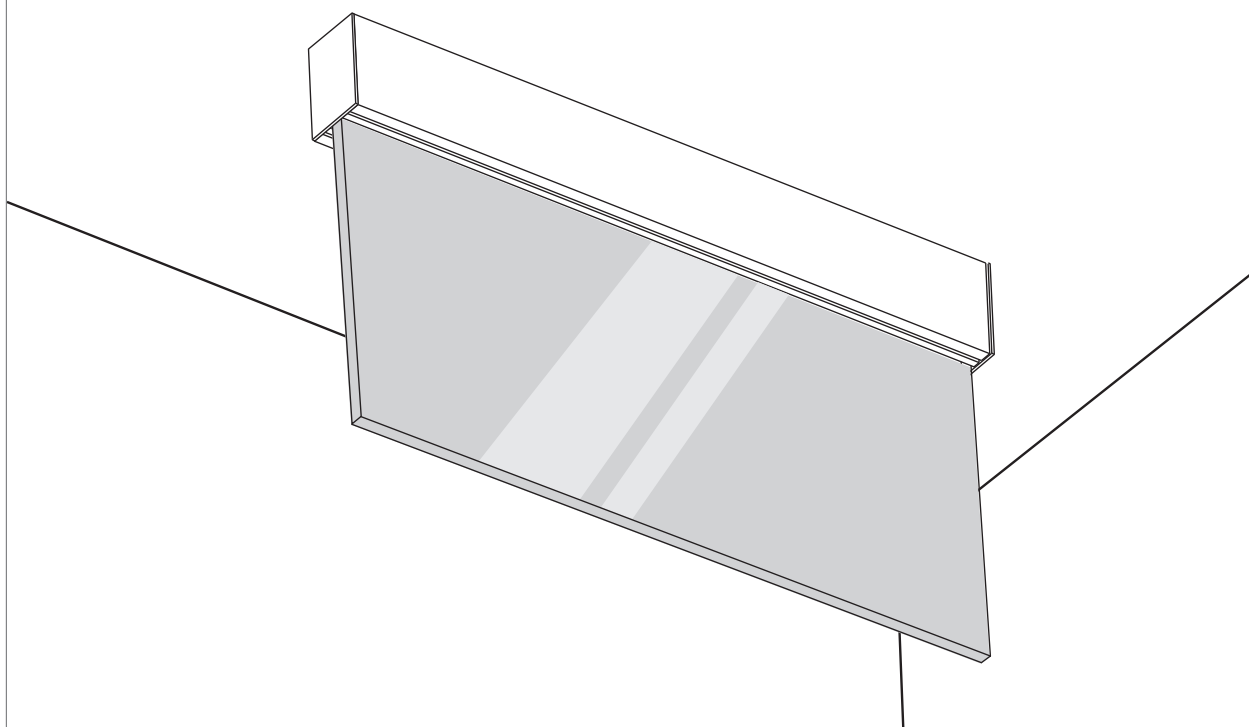

**OPTION:** end cap with hole

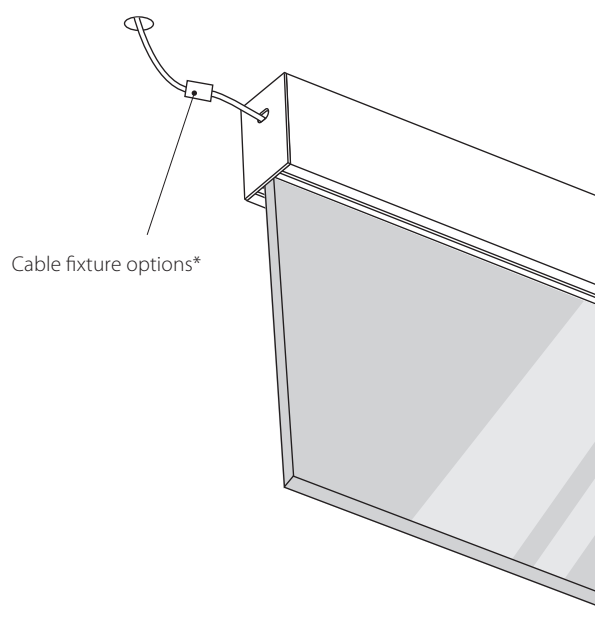
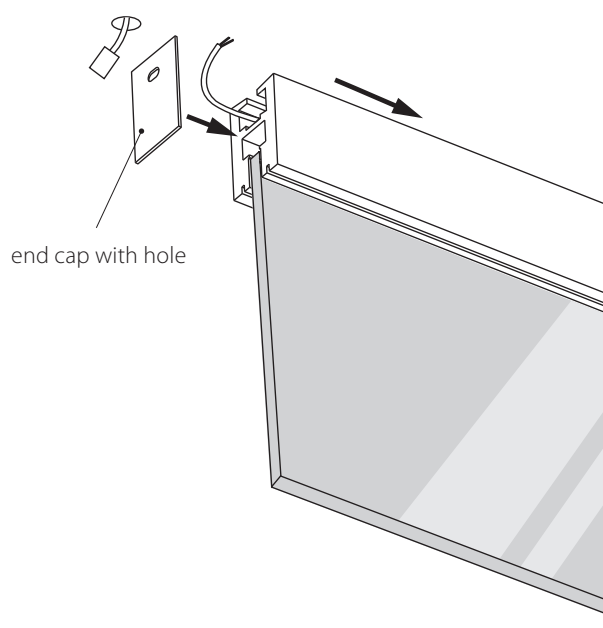

Fastener tool can be used for regulation of the extrusion's position. When locked in the mounting slit the fastener screw provides resistance against the mounting screws.

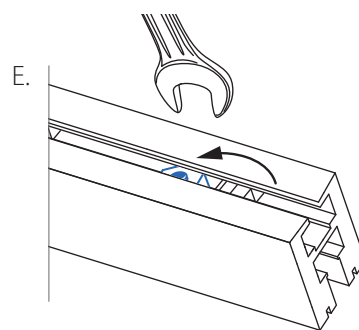
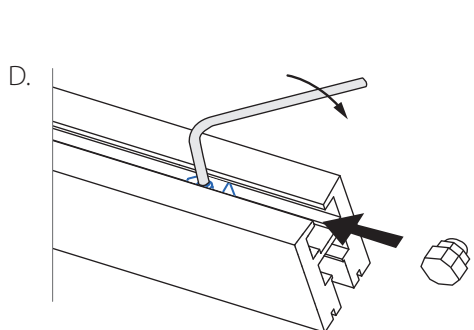
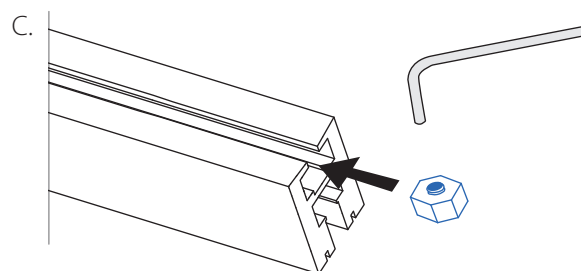
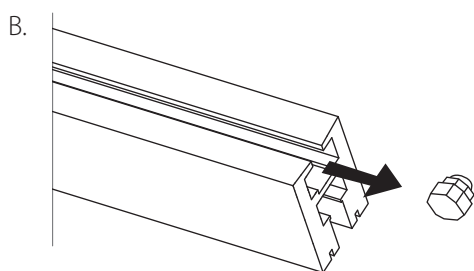
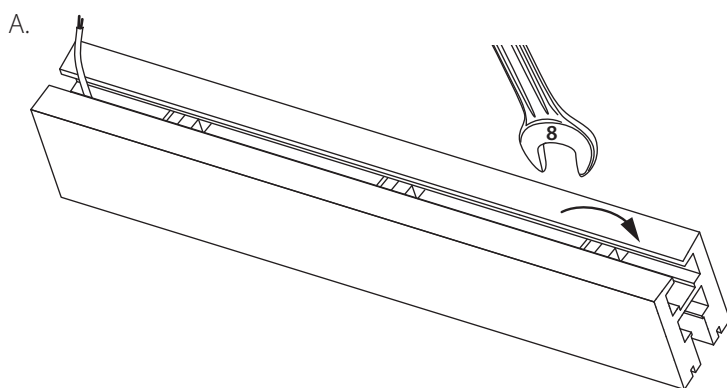
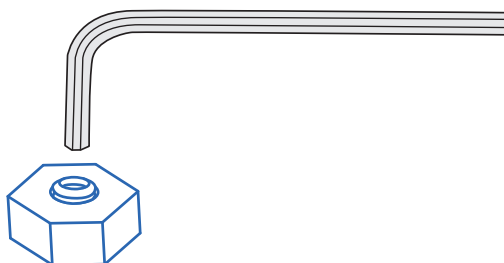

The bolt included in the fastener set can be used with the M5 mounting screws as long as there is access to them from the other side of the extrusion.

